

KIENE

DIESEL ACCESSORIES, INC.

INSTRUCTIONS: CC2056 AUXILIARY CASE ADAPTER (FOR USE WITH CC2000 CLUTCH CADDY)

APPLICATION: REMOVAL OF FULLER TRANSMISSION AUXILIARY CASES

Install CC2056 Auxiliary Case Adapter onto CC2000 Clutch Caddy as follows:

- 1.) Loosen 3/8-16 Set Screw In Pivot Block.
- 2.) Remove Clutch Holder Assembly and Install CC2056 Auxiliary Case Adapter Into Pivot Block.
- 3.) Tighten 3/8-16 Set Screw so that Adapter is free to pivot, but will not pull out of Pivot Block.
- 4.) Assemble Jacking Screw and Case Support as shown In Parts Illustration.

To remove auxiliary case:

- 1.) Loosen bolts securing the auxiliary case to the transmission case enough to allow the auxiliary case to be withdrawn approximately 1/4".
- 2.) Position Auxiliary Case Adapter (mounted on Clutch Caddy) under auxiliary case and raise Adapter so that it contacts bottom of auxiliary case. Turn Adjusting Screw as required, so that the auxiliary case sits flat on the Adapter. **DO NOT USE IMPACT WRENCH ON ADJUSTING SCREW.** The (4) Stop Posts must be positioned between the auxiliary case and transmission case flanges.
- 3.) Loosen (2) Clamping Nuts on the Auxiliary Case Support. Remove a lower bolt from the auxiliary case countershaft bearing cover and attach the Auxiliary Case Support (see Illustration). Tighten Clamping Nuts.
- 4.) Turn Jack Screw until it contacts underside of auxiliary case.
- 5.) Remove bolts securing auxiliary case to transmission case.
- 6.) Pull Adapter, with auxiliary case attached, away from transmission.

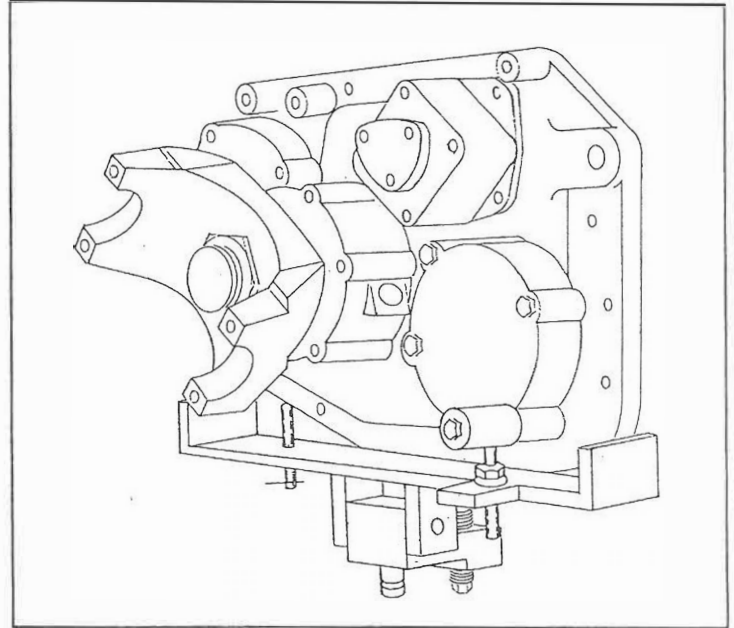

To install auxiliary case:

- 1.) Mount auxiliary case onto Adapter, as described in steps 1 thru 4 above.
- 2.) Position Adapter (mounted on Clutch Caddy), with attached auxiliary case, at the rear of the transmission. Adjust height using Clutch Caddy controls. Tilt auxiliary case to match transmission case, using Adjusting Screw on Adapter. **DO NOT USE IMPACT WRENCH ON ADJUSTING SCREW.**
- 3.) Push auxiliary case into transmission.

PARTS ILLUSTRATION

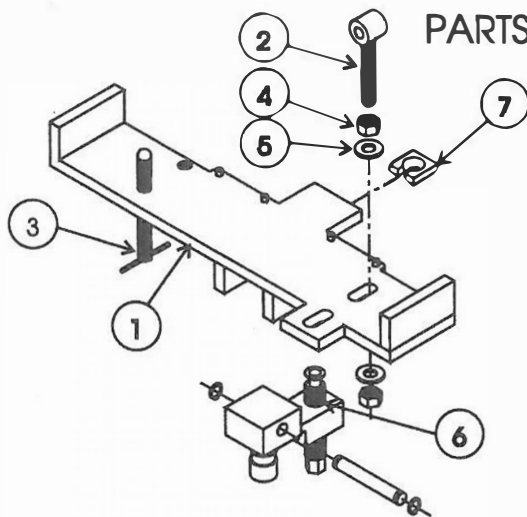

- 1 CC2056-1 ADAPTER PLATE
- 2 CC2056-2 CASE SUPPORT
- 3 CC2056-7 JACKING SCREW
- 4 202-61440 1/2-13 HEX NUT (2 REQ'D.)
- 5 206-63028 1/2 SAE FLAT WASHER (2 REQ'D.)
- 6 CC2057-4 ADJUSTING SCREW
- 7 CC2057-5 ADJUSTING SCREW BUSHING

KIENE
DIESEL ACCESSORIES, INC.

WWW.UNIQUETRUCK.COM
616-531-8868

UNIQUE
TRUCK EQUIPMENT

(2056INS.CDR)